



tabbies®
EXHIBIT
1

2000 I-30 E
Greenville, TX 75402

Thursday, May 4, 2023

Office of Hopkins County Judge
PO Box 288
Sulphur Springs TX 75483

Farmers Electric Cooperative Member: **CODY NIXON**
Service Order Number: **2023036339**

Greetings:

Farmers Electric Cooperative, Inc. is requesting permission to construct electrical power distribution facilities which will cross County Road 2328 which is located 3500' E OF FM 1567 E in Hopkins County, Texas.

Site location map and construction sketches are enclosed. The construction sketch details the proposed work. All underground bore crossings are PVC encased 4' of coverage from the lowest point of the Right of Way.

If you have any questions, please contact me at any time.

Sincerely,

Catherine Rollins

Project Coordinator
crollins@farmerselectric.coop
Phone 903-513-0259

Submitted by Psalm Harper
pharper@farmerselectric.coop
Engineering Coordinator

Enclosures

County Approval Section:

Approved: J Denied: _____

Authorized Signature: *Pharm Harper*

Date: 5-8-2023

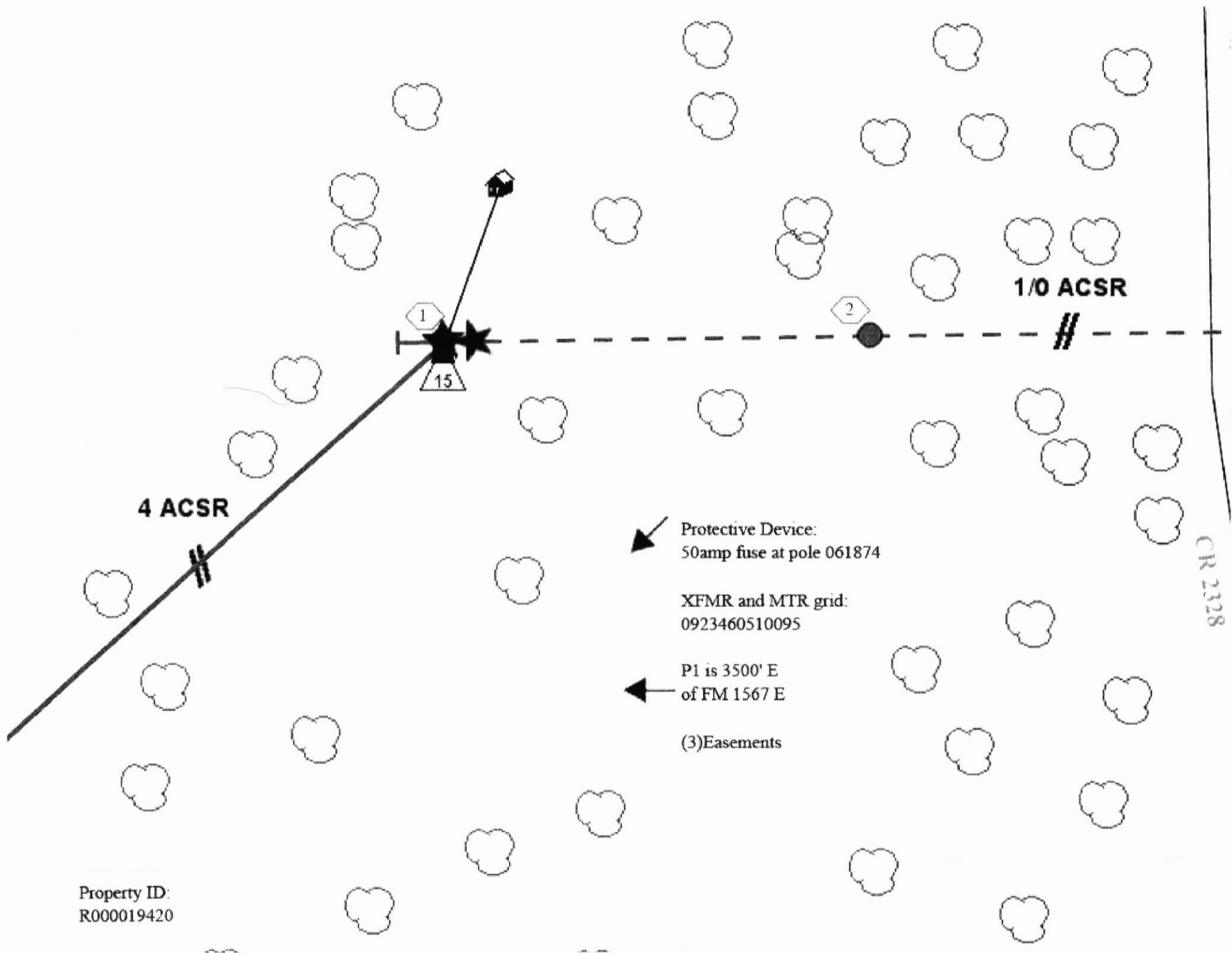

4 ACSR

1/0 ACSR

1
15

2

Protective Device:
50amp fuse at pole 061874

XFMR and MTR grid:
0923460510095

P1 is 3500' E
of FM 1567 E

(3)Easements

CR 2328

Property ID:
R000019420

34

MARTIN ALEXANDER

75431

COMO-PICKTON ISD

23460510085



234605

34

23460510095

County Road 2328

234605